

RF SERIES – 120 MINUTE FIRE U.L. LISTED HIGH SECURITY

AMSEC offers the only gun safes that have a TL-30 and TL-30x6 Six-Sided UL Burglary Rating. To earn a TL-30 or TL-30x6 UL Burglary Rating, these safes are subjected to a brutal 30-minute attack by trained technicians using tools such as sledge hammers, picks, chisels, circular saws, carbide drills, wedges, and pry bars. These safes are the industry standard for protecting assets against the threat of serious attack.

The high level of security of these safe comes from AMSEC's unique composite construction. High-strength concrete with proprietary aggregate combined with a matrix of formed steel barriers stop types of attacks outlined in the Underwriters Laboratories standard. These massive safes weigh between 3,400 and 4,500 pounds. No one is walking out of your house with one of these.

This is the same safe construction that AMSEC sells to banks and jewelers across the county. Today there are hundreds of millions of dollars' worth of assets protected by AMSEC High-Security Composite Safes.



RF703620X6

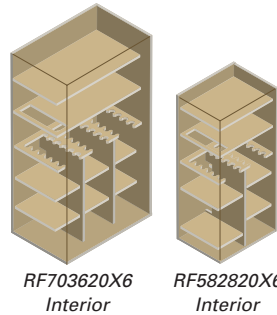

RF703620X6 Interior

RF582820X6 Interior



RF6528

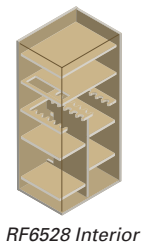

RF6528 Interior

Model	Outside Dim H x W x D	Interior Capacity	Weight Lbs.
RF703620X6	76" x 42" x 29¼"	12-12-12-24-36 Gun 58 + 2 Gun	4,578
RF582820X6	64" x 34" x 29¼"	12-12-24 Gun + 2 Gun	3,418
RF6528	72" x 35" x 29½"	12-12-24 Gun + 2 Gun	3,455

SECURITY

- 6" Thick High Security Composite Door
- 3½" Thick High Security Body (3" on X6)
- UL Listed TL-30 or TL-30X6 High Security Burglary Classification
- 10 Massive 1½" Chrome Plated Bolts

FIRE PROTECTION

- Seamless High Security Composite Fill
- 120-Minute Certified Fire Rating
- Palusol Door Seal Protects Against Fire and Smoke

FUNCTIONALITY

- Industry's Most Flexible Interior
- Door Organizer
- Storage for Two Long Guns or Assault Rifles on Door



HIGH-GLOSS COLORS (AVAILABLE ON RF6528 ONLY)

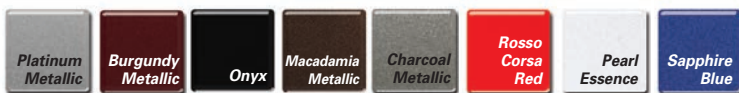

TEXTURED COLORS (ALL MODELS)

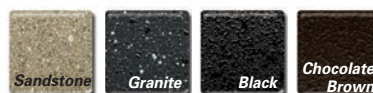

HARDWARE COLORS

